

Video: adding a question compare dashlet

01/31/2024 1:29 pm EST

This guide will walk you through the steps to add a question compare dashlet to a dashboard.

Your browser does not support HTML5 video.

1. Go to insightstore.civicscience.com
2. From the landing page, click *Dashboard*.

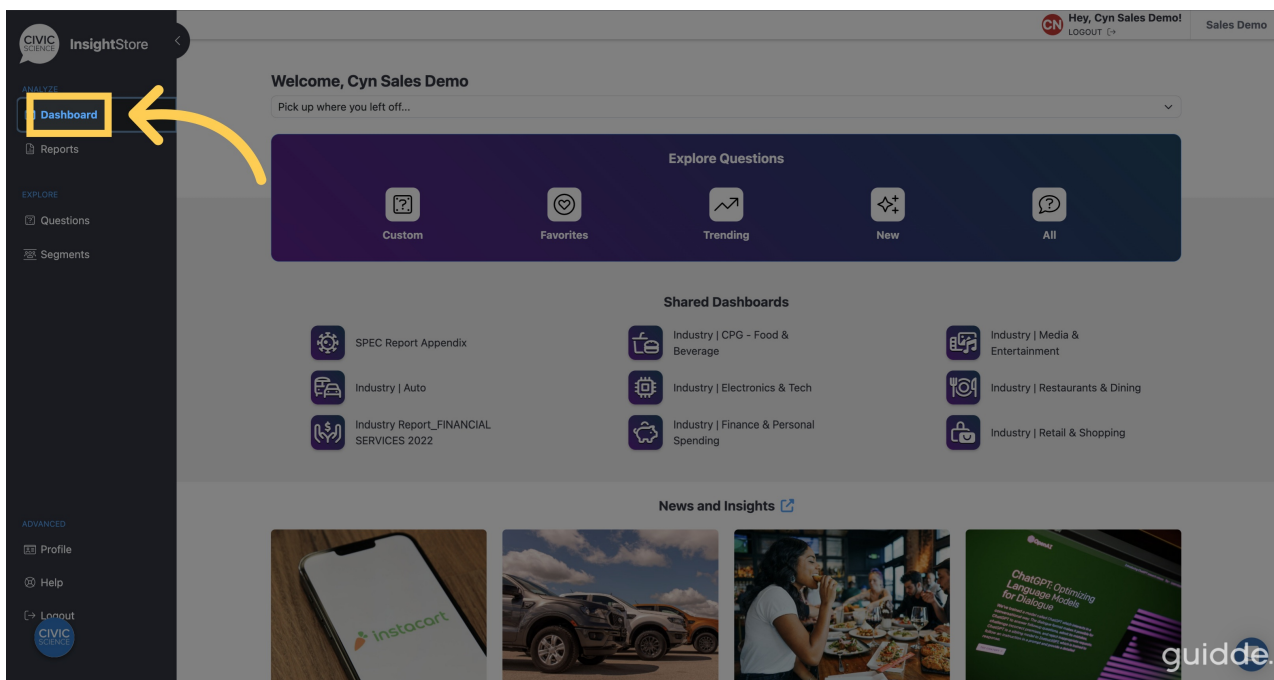

3. Go to the *Dashboard* dropdown menu.

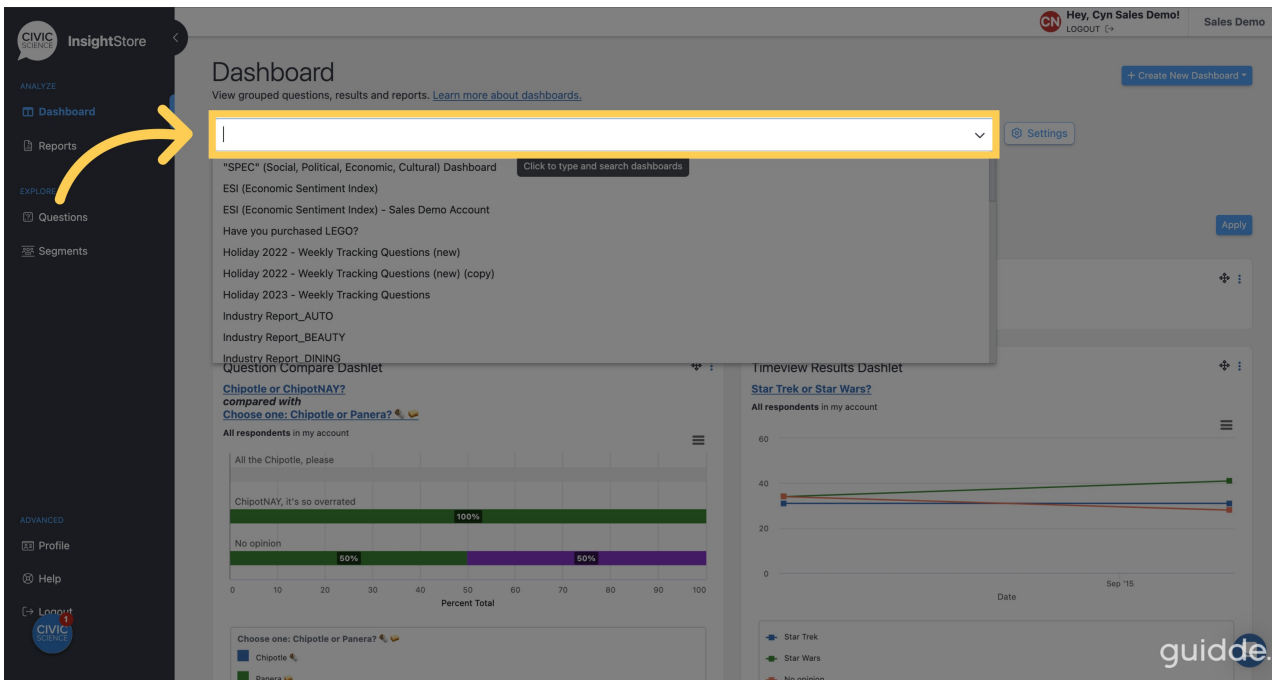

4. Select your dashboard from the list.

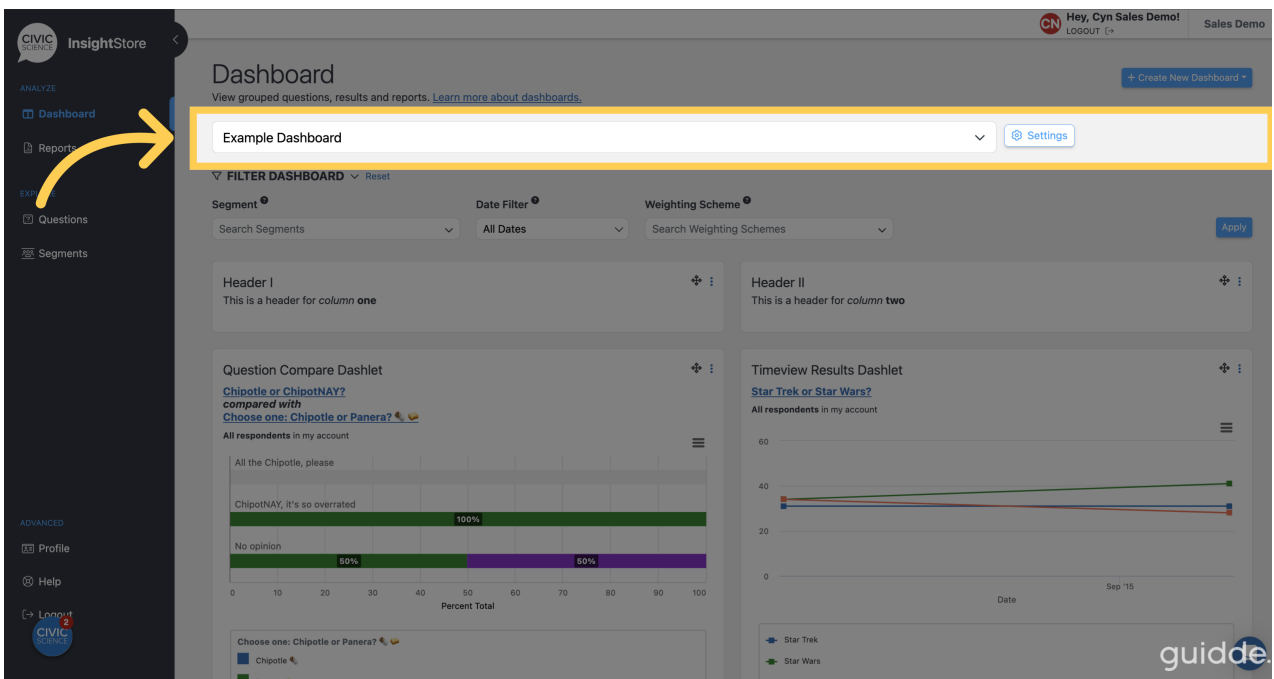

5. Go to the bottom of the dashboard and click *Add New Dashlet*.

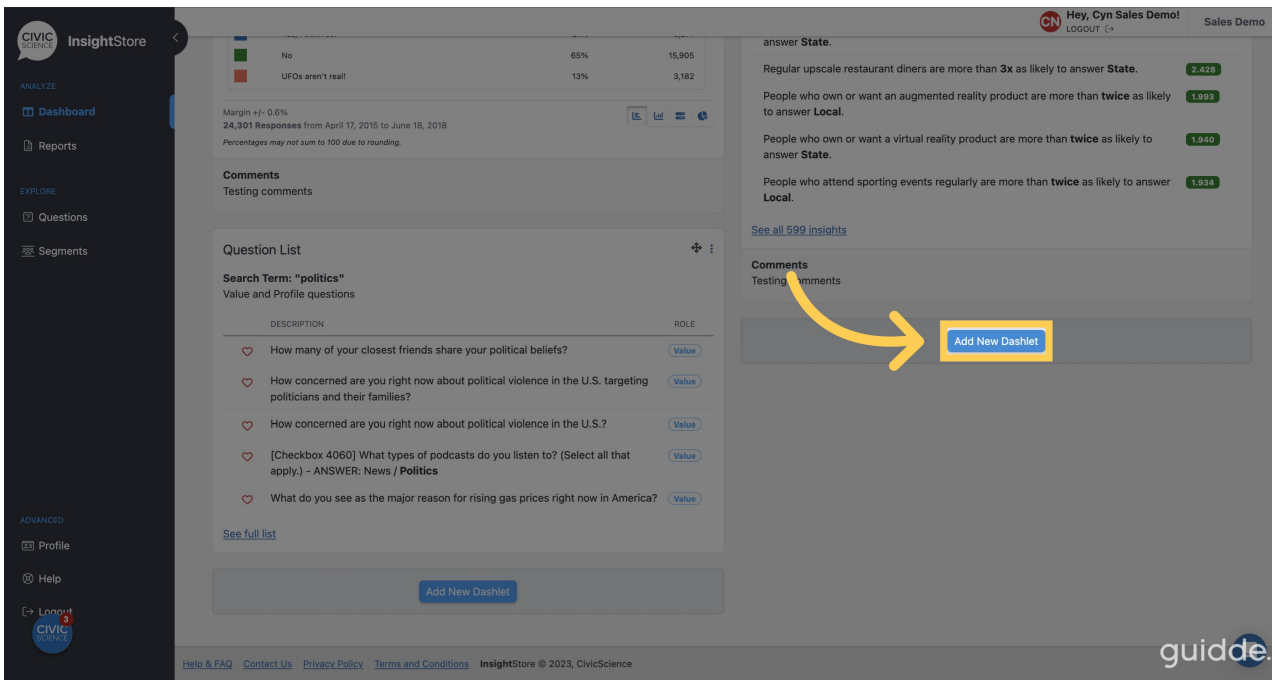

6. Select *Question Compare* from the dropdown list.

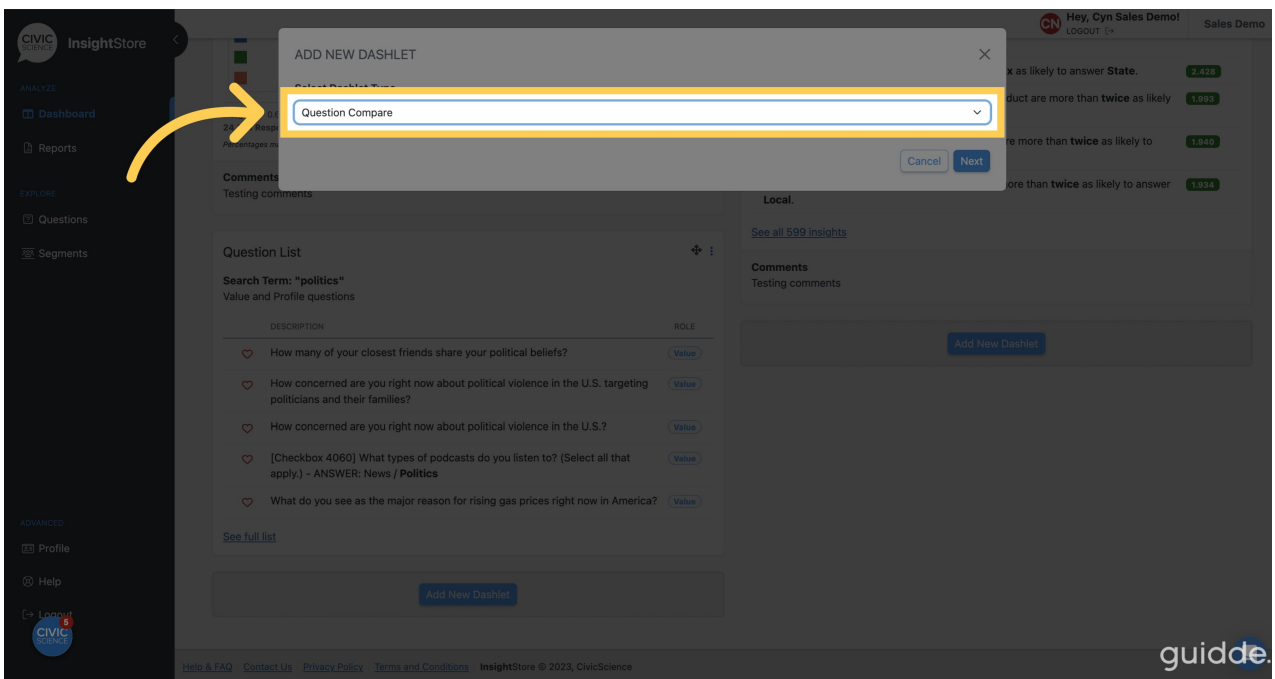

7. Click *Next* to continue.

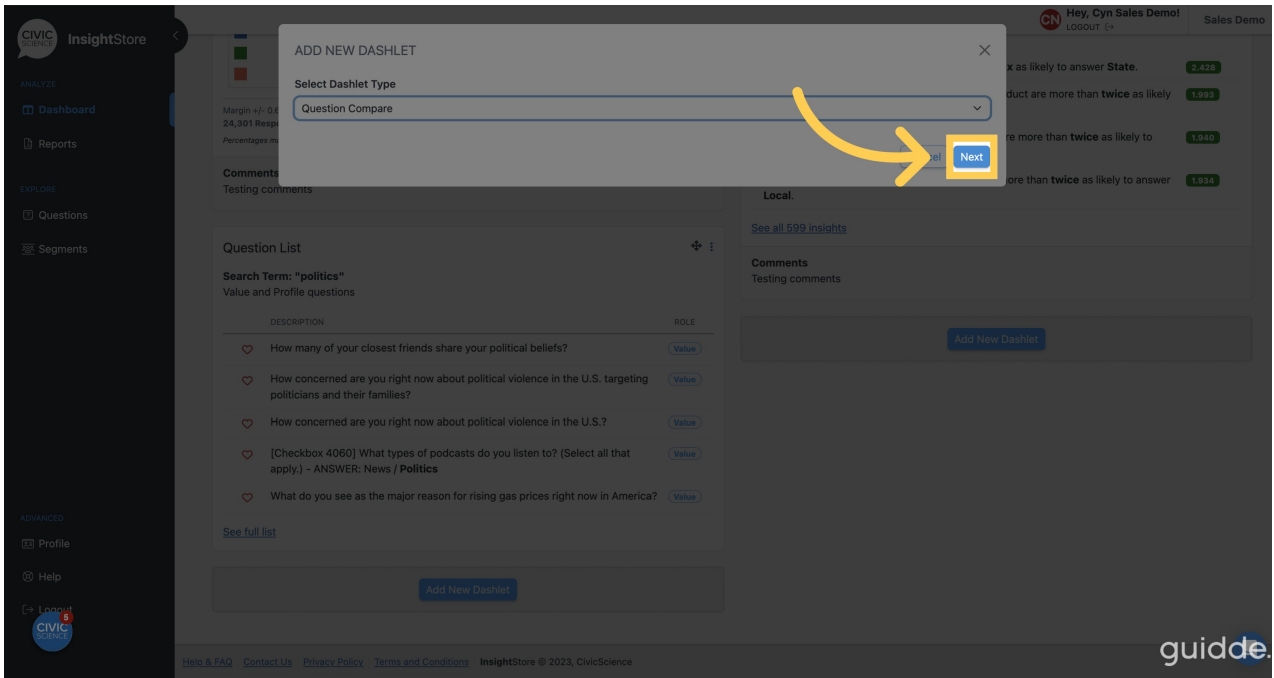

8. Go to the *Dashlet Name* field.

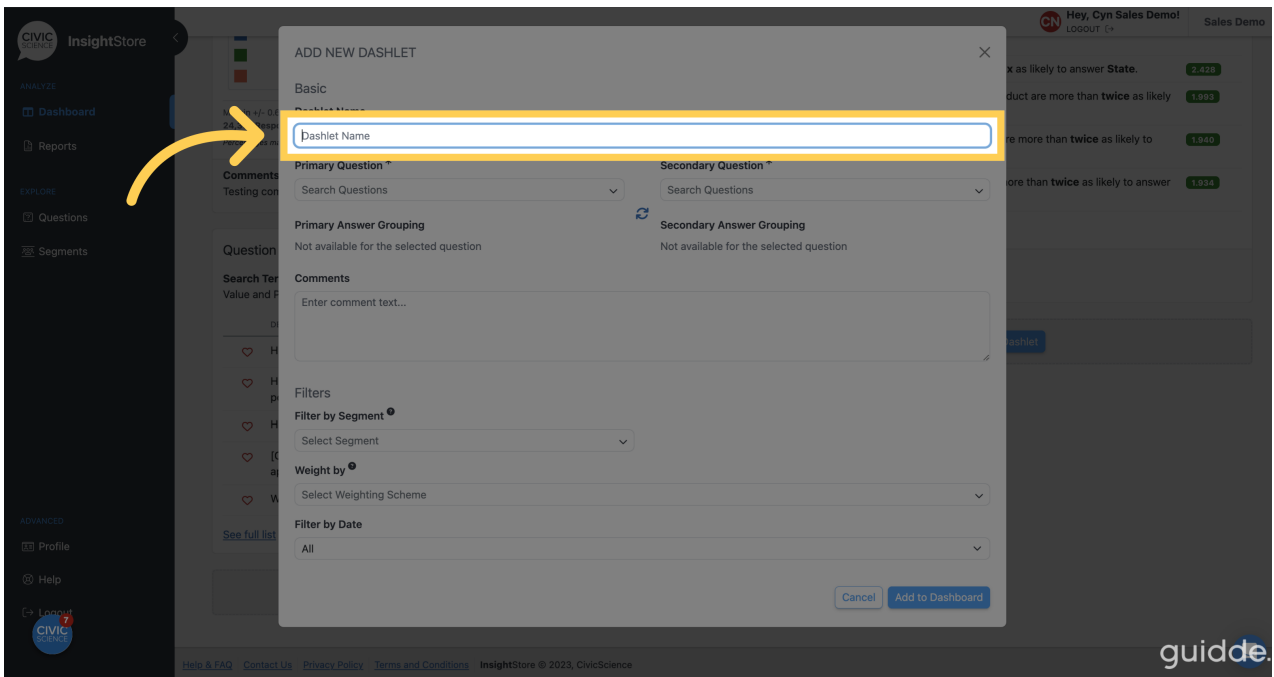

9. Enter a descriptive name for your dashlet.

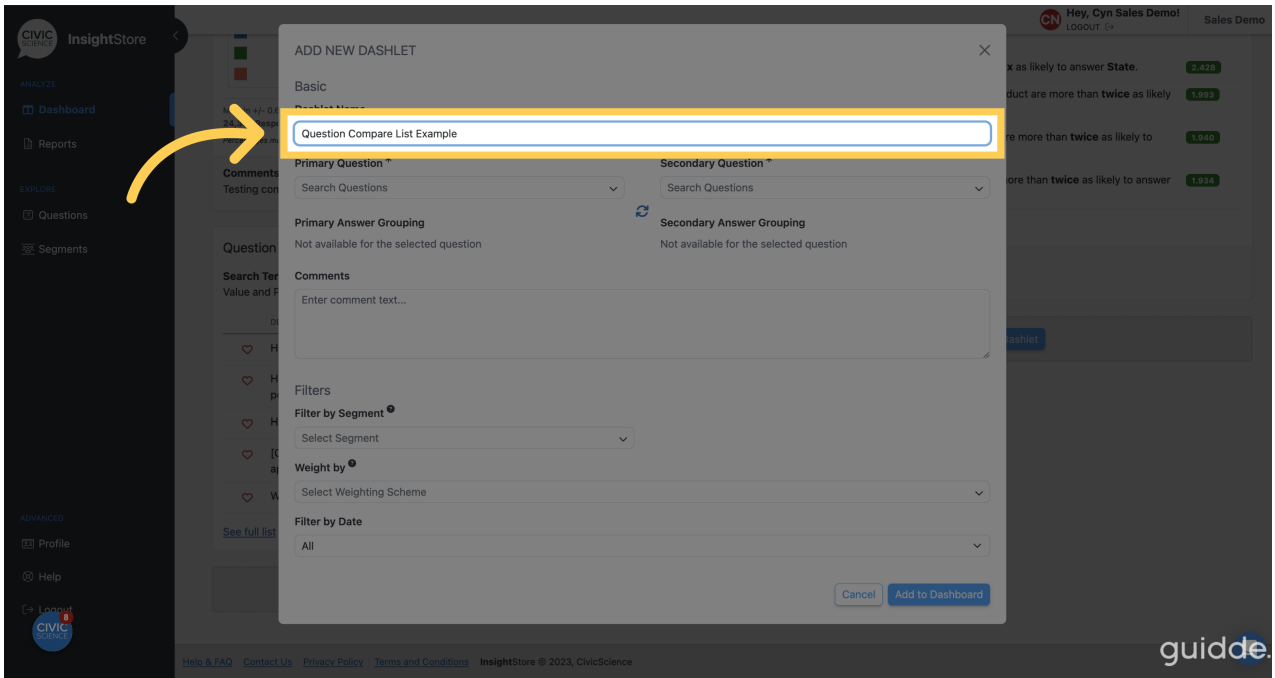

10. Go to the *Primary Question* search field.

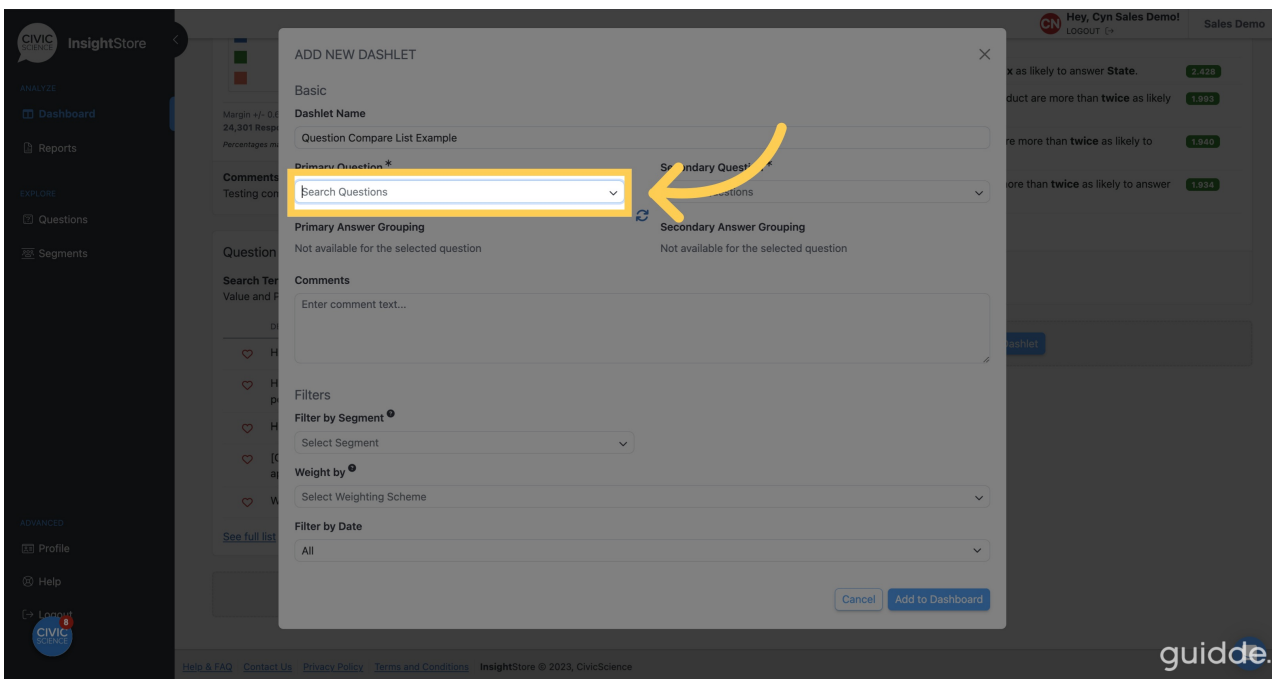

11. Enter an ID or search criteria for the first question.

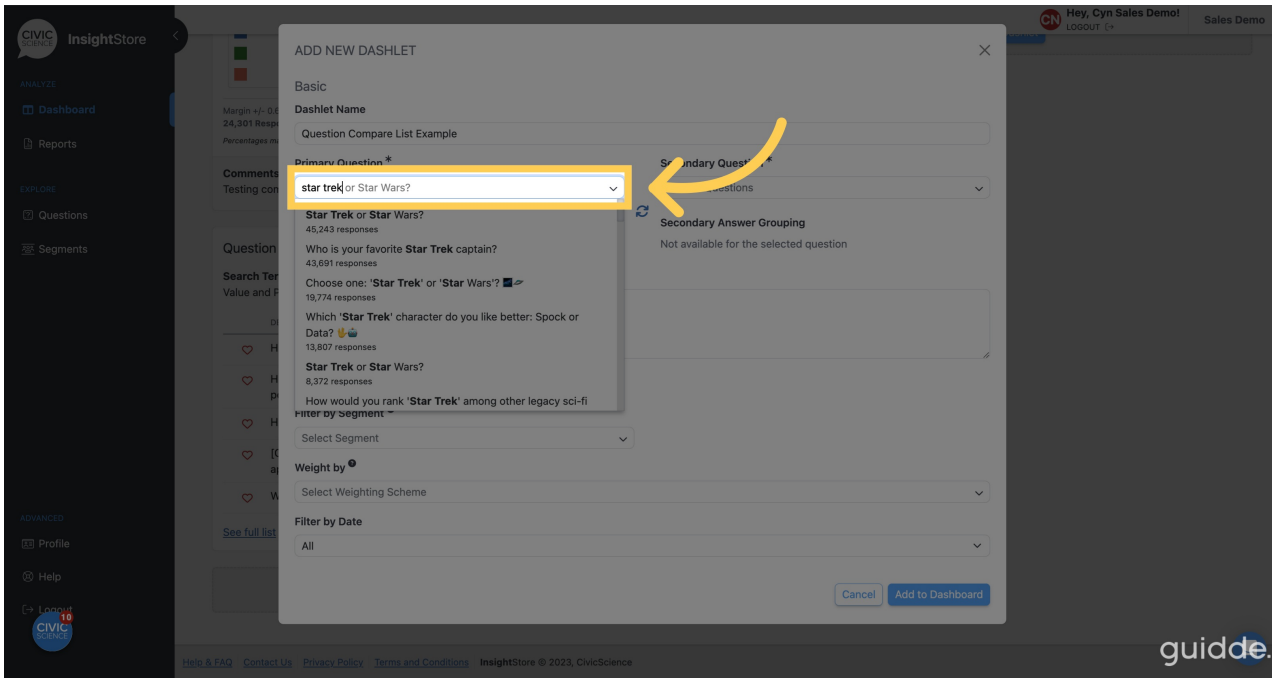

12. Choose your question from the results list.

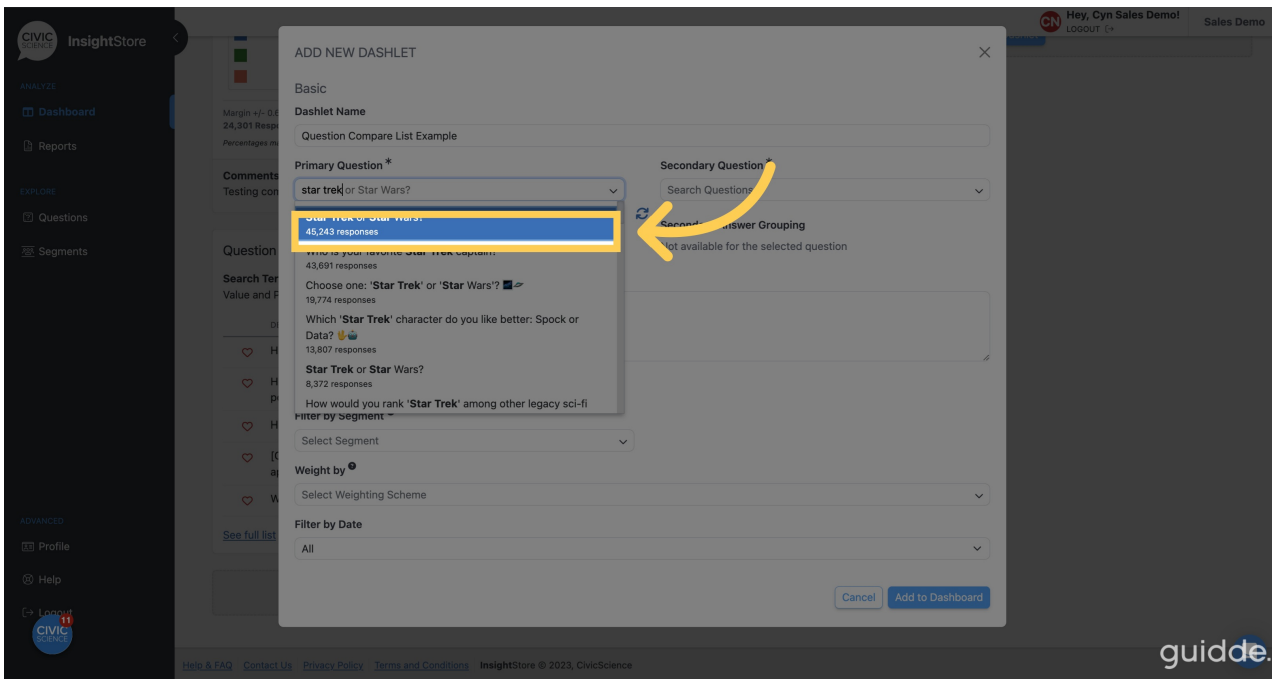

13. Go to the *Secondary Question* search field.

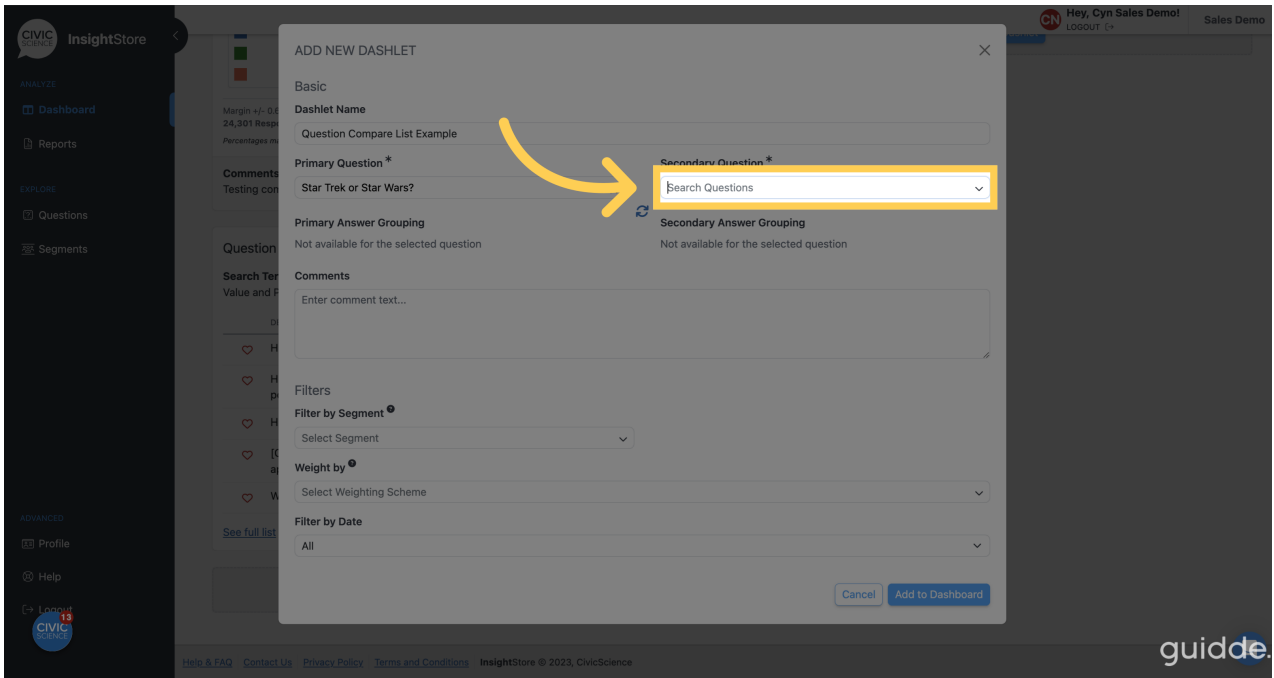

14. Enter the ID or search criteria for your second question.

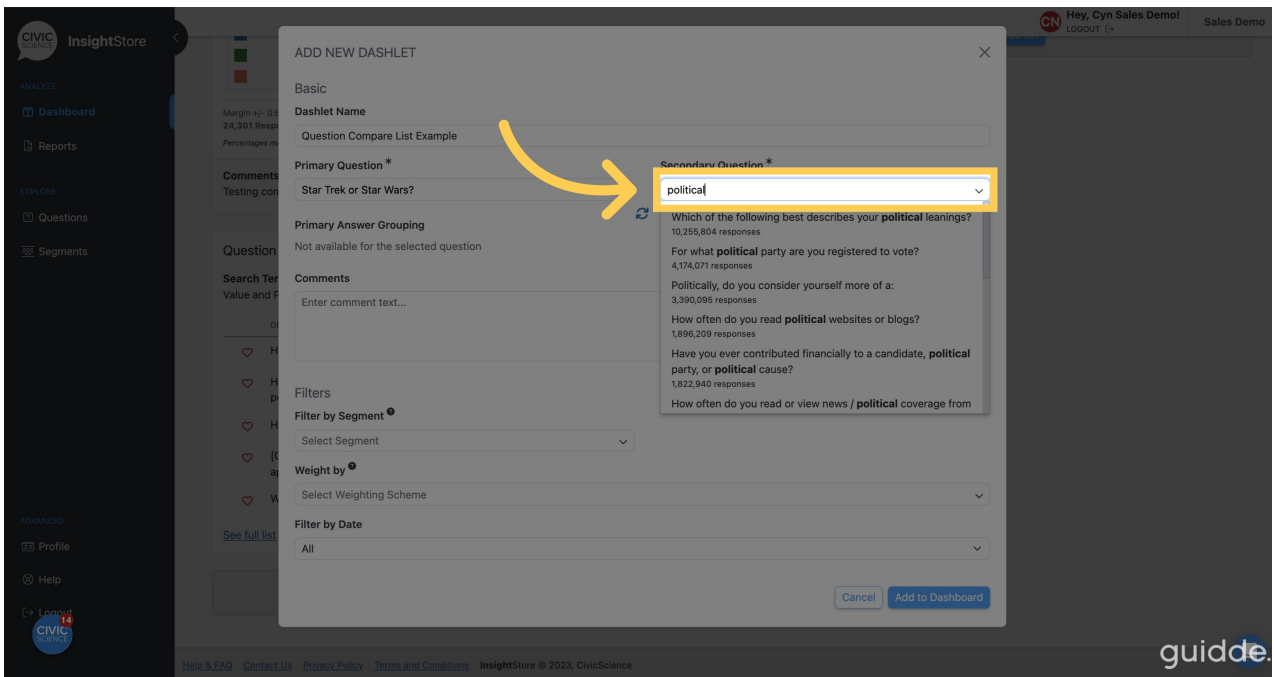

15. Select your question from the results list.

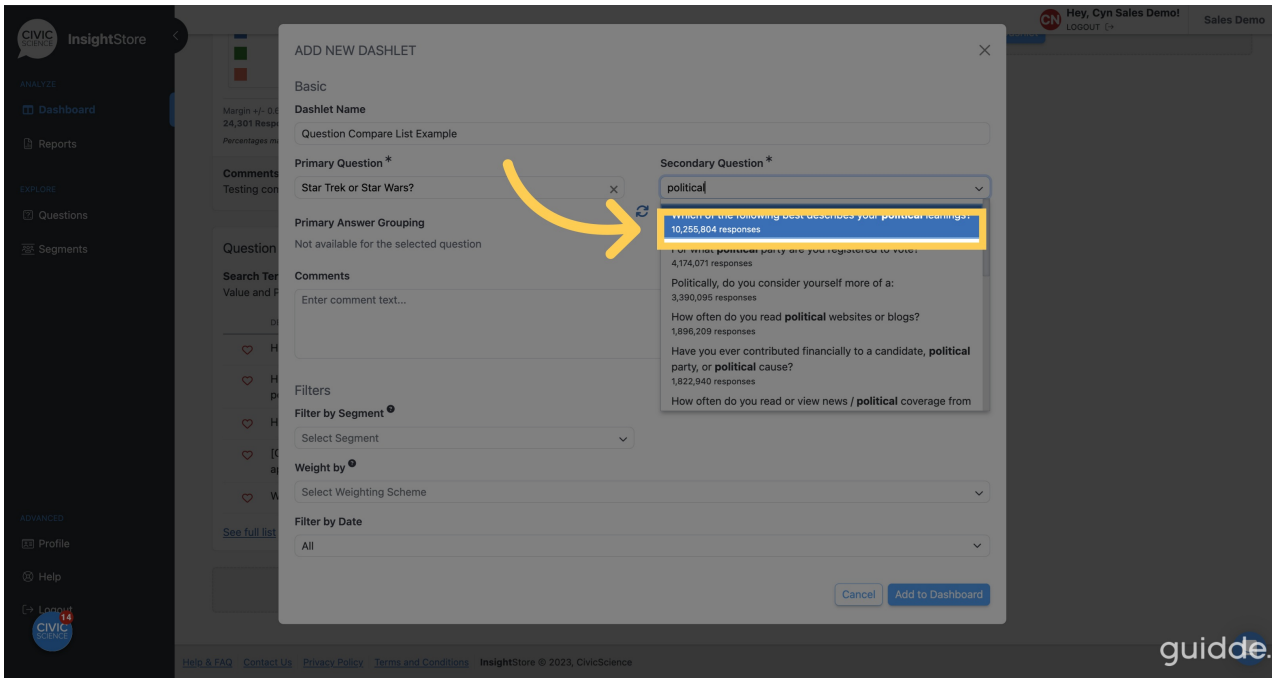

16. Enter any desired comments in the *Comment* field. You may use **basic markdown** to format them.

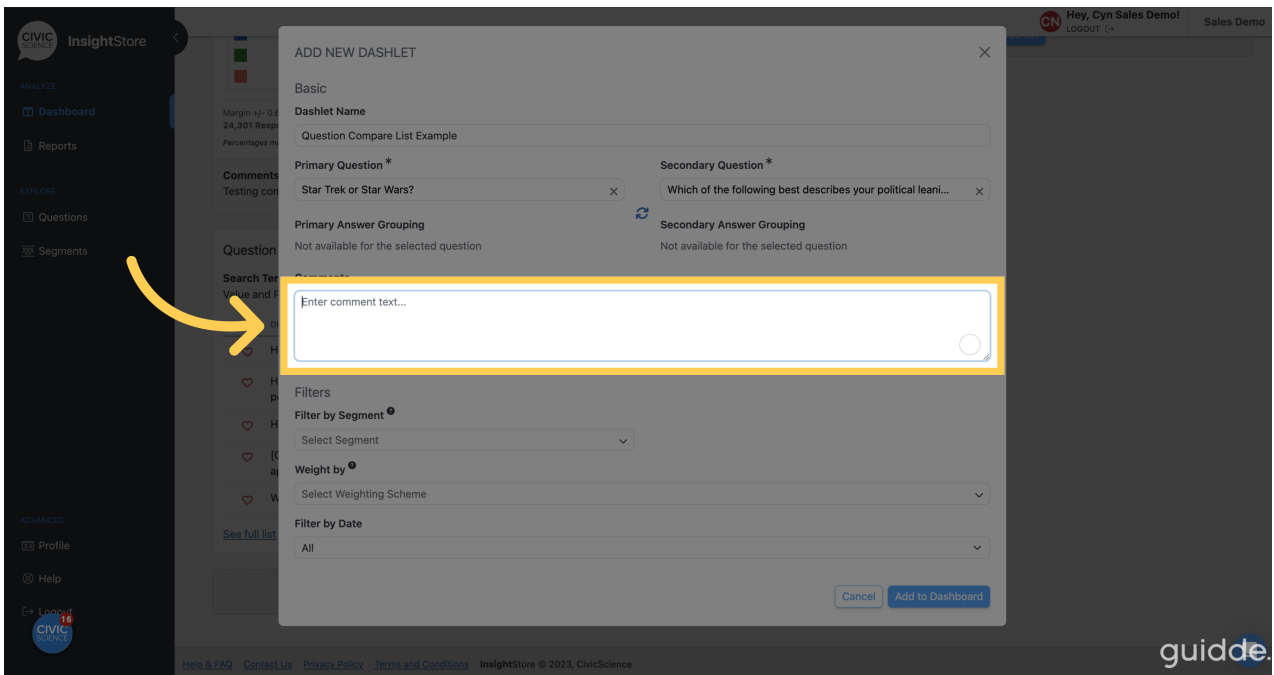

17. Choose a segment if desired.

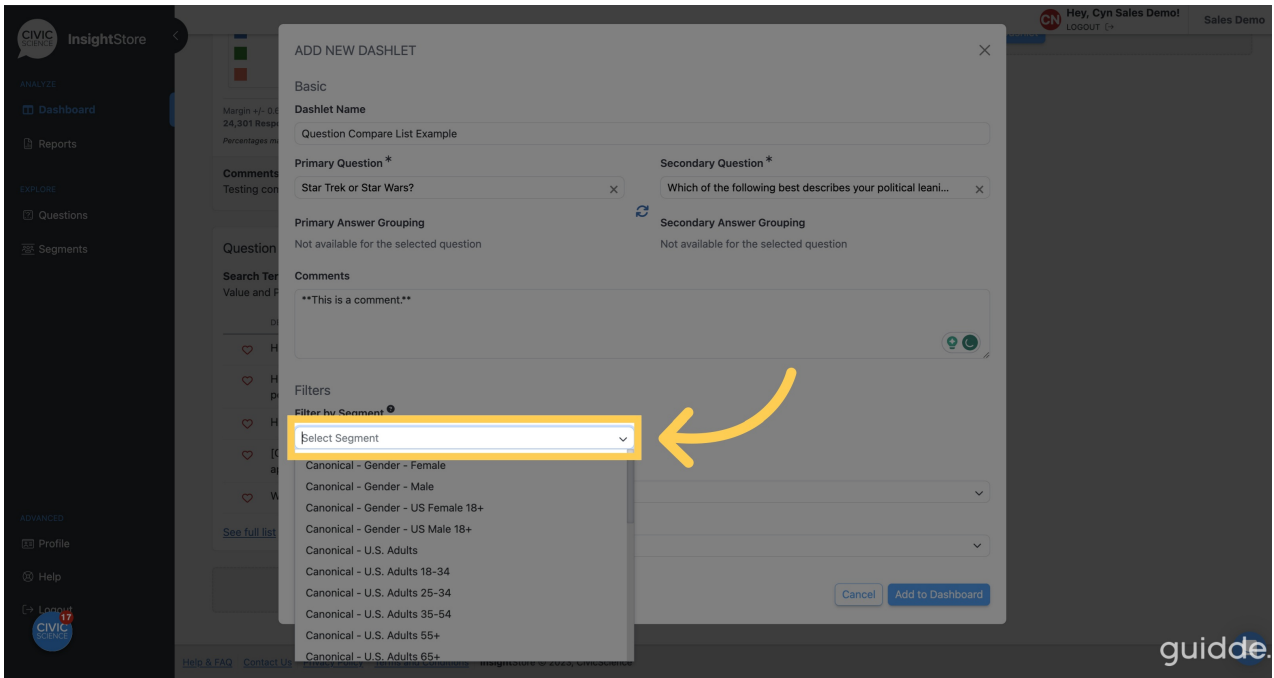

18. Apply a weighting scheme.

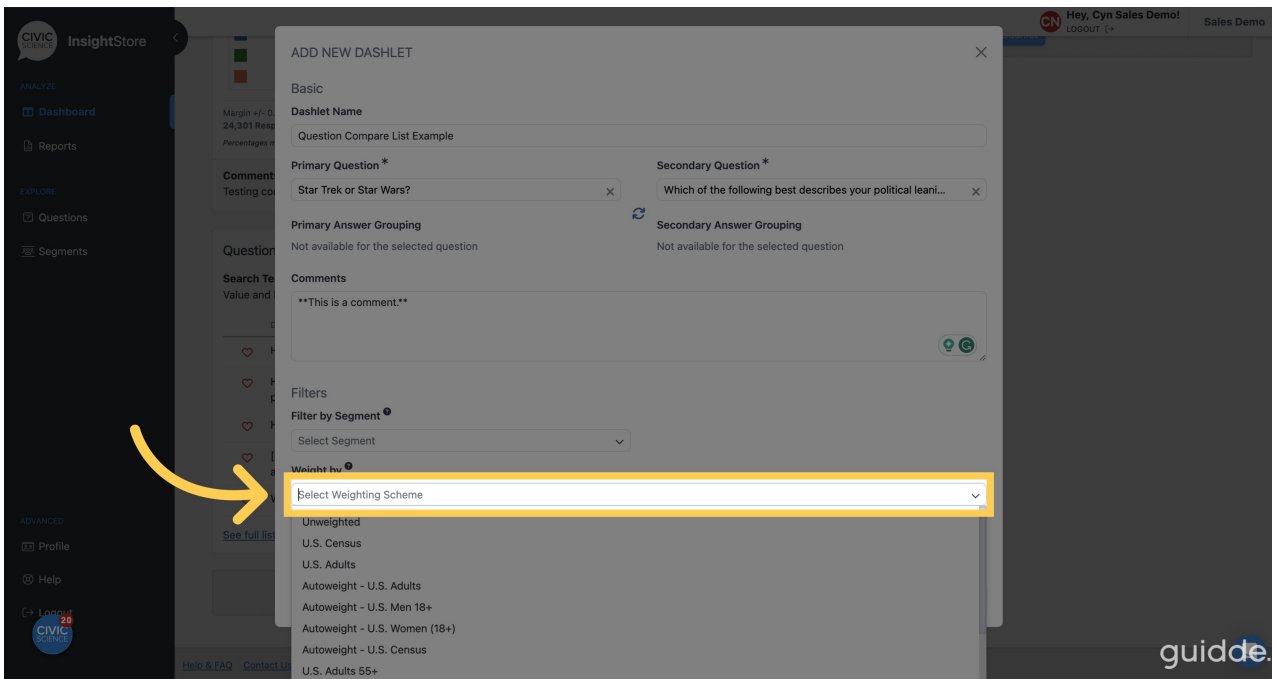

19. Choose a date filter if needed.

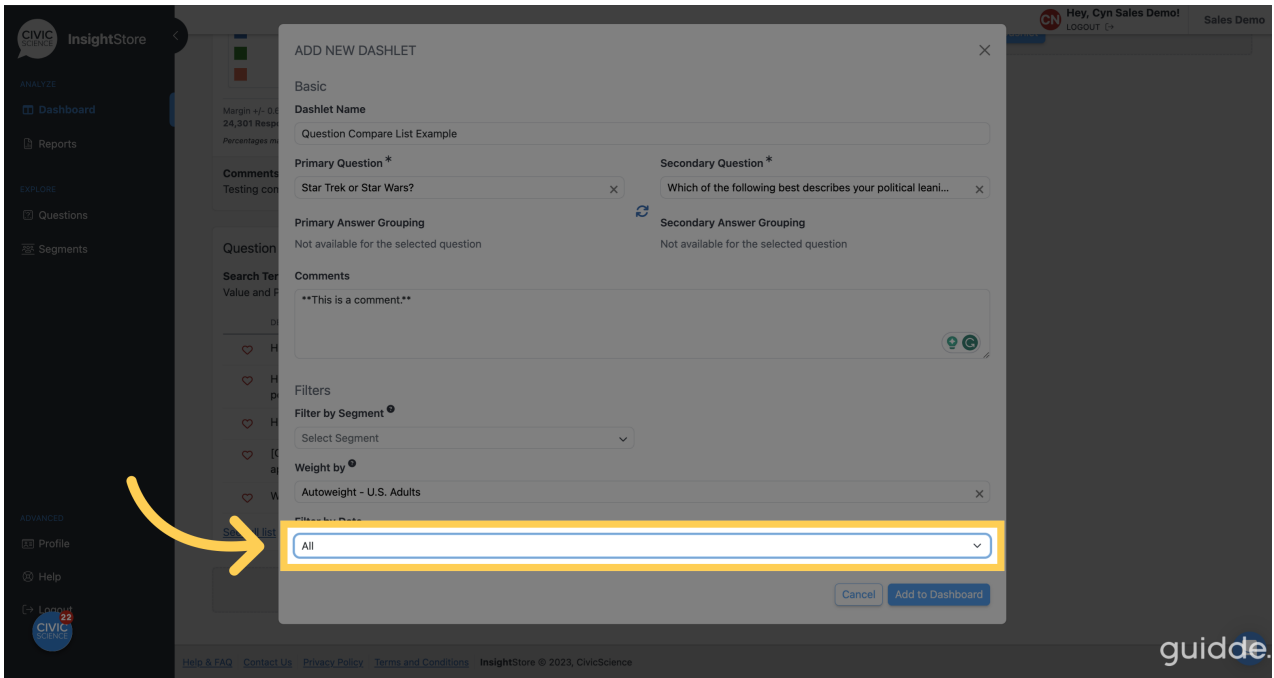

20. Click *Add to Dashboard* and view your new dashlet.

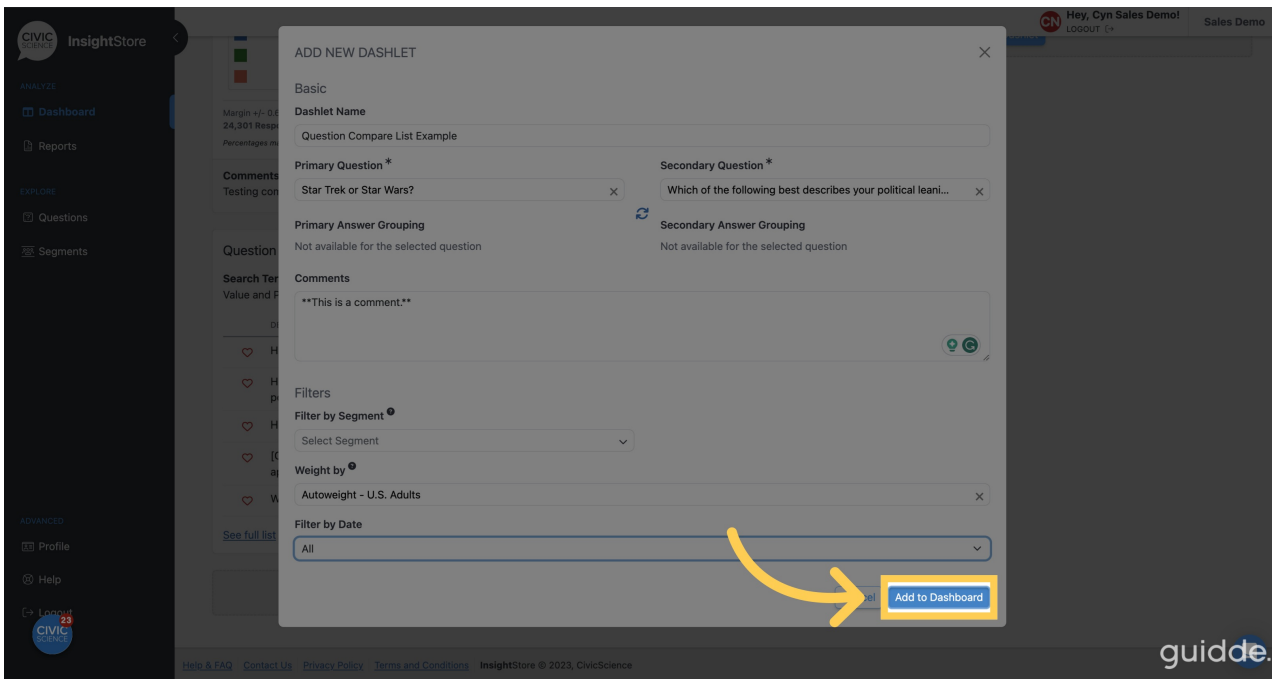

21. To relocate the dashlet, click the move cursor symbol and drag the dashlet to its desired position.

InsightStore

Hey, Cyn Sales Demo! LOGOUT (-)

Sales Demo

ANALYZE

- Dashboard
- Reports

EXPLORE

- Questions
- Segments

ADVANCED

- Profile
- Help

Logout 24 CIVIC SCIENCE

133%

0 10 20 30 40 50 60 70 80 90 100

Yes, I think so!	21%	5,214
No	65%	15,905
UFOs aren't real!	13%	3,182

Margin +/- 0.6%

24,301 Responses from April 17, 2015 to June 18, 2018

Percentages may not sum to 100 due to rounding.

Comments

Testing comments

Question List

Search Term: "politics"

Value and Profile questions

DESCRIPTION	ROLE
How many of your closest friends share your political beliefs?	Value
How concerned are you right now about political violence in the U.S. targeting politicians and their families?	Value
How concerned are you right now about political violence in the U.S.?	Value
[Checkbox 4060] What types of podcasts do you listen to? (Select all that apply.) - ANSWER: News / Politics	Value
What do you see as the major reason for rising gas prices right now in America?	Value

See full list

Comments

Testing comments

Question Compare List Example

Star Trek or Star Wars?
compared with
Which of the following best describes your political leanings?

All respondents in my account weighted according to Autoweight - U.S. Adults

Question	Conservative	Moderate	Liberal
Star Trek	43%	31%	28%
Star Wars	40%	39%	21%
Neither is superior in my opinion; both great in their own ways	37%	35%	27%
Not a fan	41%	34%	24%
I don't have an opinion on this	46%	31%	23%

0 10 20 30 40 50 60 70 80 90 100

Percent Total

Which of the following best describes your political leanings?

- Conservative
- Moderate
- Liberal

7,863 Responses. Significance: $X^2_{(df=2)}=43.132, p=0.000$, Low Strength of Association($T=0.044$)

Comments

This is a comment.

guide.

22. To edit the dashlet, click the kebab menu.

InsightStore

Hey, Cyn Sales Demo! LOGOUT (-)

Sales Demo

ANALYZE

- Dashboard
- Reports

EXPLORE

- Questions
- Segments

ADVANCED

- Profile
- Help

Logout 25 CIVIC SCIENCE

0.512

See all 421 Insights

Comments

This is a comment.

Question List Example Dashlet

Search Term: "television"

Value and Profile questions

DESCRIPTION	ROLE
How much do your friends and other contacts on social media influence the movies and television shows you watch?	Value
How much would you say you watch reality TV in an average week?	Value
How much would you say you watch sitcoms on TV in an average week?	Value
How much would you say you watch documentaries on TV in an average week?	Value
How much would you say you watch dramas on TV in an average week?	Value

See full list

Comments

This is a sample comment.

Question Compare List Example

Star Trek or Star Wars?
compared with
Which of the following best describes your political leanings?

All respondents in my account weighted according to Autoweight - U.S. Adults

Question	Conservative	Moderate	Liberal
Star Trek	43%	31%	28%
Star Wars	40%	39%	21%
Neither is superior in my opinion; both great in their own ways	37%	35%	27%
Not a fan	41%	34%	24%
I don't have an opinion on this	46%	31%	23%

0 10 20 30 40 50 60 70 80 90 100

Percent Total

Which of the following best describes your political leanings?

- Conservative
- Moderate
- Liberal

6,832 Responses from June 19, 2015 to October 9, 2015

Percentages may not sum to 100 due to rounding.

Comments

This is a sample comment.

guide.

23. Select *Settings* from the dropdown menu.

The screenshot shows the CIVIC SCIENCE InsightStore interface. On the left is a navigation sidebar with sections: ANALYZE (Dashboard, Reports), EXPLORE (Questions, Segments), and ADVANCED (Profile, Help). The main content area is divided into several sections:

- Top Section:** A header with a score of 0.512 and a donut chart showing 40% (Count: 2,743) for Star Wars, 28% for Star Trek, and 31% for No opinion.
- Comments:** A section with a sample comment: "This is a comment."
- Question List Example Dashlet:** A list of questions related to television watching habits, each with a "Value" button.
- Question Results:** A bar chart showing results for the question "Have you ever seen a UFO?".
- Question Compare List Example:** A comparison of "Star Trek or Star Wars?" with a question about political leanings. It features a stacked bar chart with data:

Response	Star Trek	Star Wars	No opinion
Star Trek	43%	31%	26%
Star Wars	40%	39%	21%
Neither is superior in my opinion; both great in their own ways	37%	35%	27%
Not a fan	41%	34%	24%
I don't have an opinion on this	44%	31%	23%

 A yellow arrow points from the "Settings" button in the top right of the "Question Compare List Example" section to the next step.

24. Make any desired changes.

The screenshot shows the same CIVIC SCIENCE InsightStore interface, but with a "QUESTION COMPARE" dialog box open in the center. The dialog box has the following fields:

- Basic:** Dashlet Name (Question Compare List Example)
- Primary Question*:** Star Trek or Star Wars?
- Secondary Question*:** Which of the following best describes your political leanings?
- Primary Answer Grouping:** Not available for the selected question
- Secondary Answer Grouping:** Not available for the selected question
- Filters:** Filter by Segment (Select Segment), Weight by (Autoweight - U.S. Adults), Filter by Date (All)
- Comments:** A text area containing the text "**This is a comment**", which is highlighted with a yellow box and a yellow arrow.

 At the bottom of the dialog box are "Cancel" and "Submit" buttons. The background interface is dimmed.

25. Click *Submit* to save your changes and view the updated dashlet.

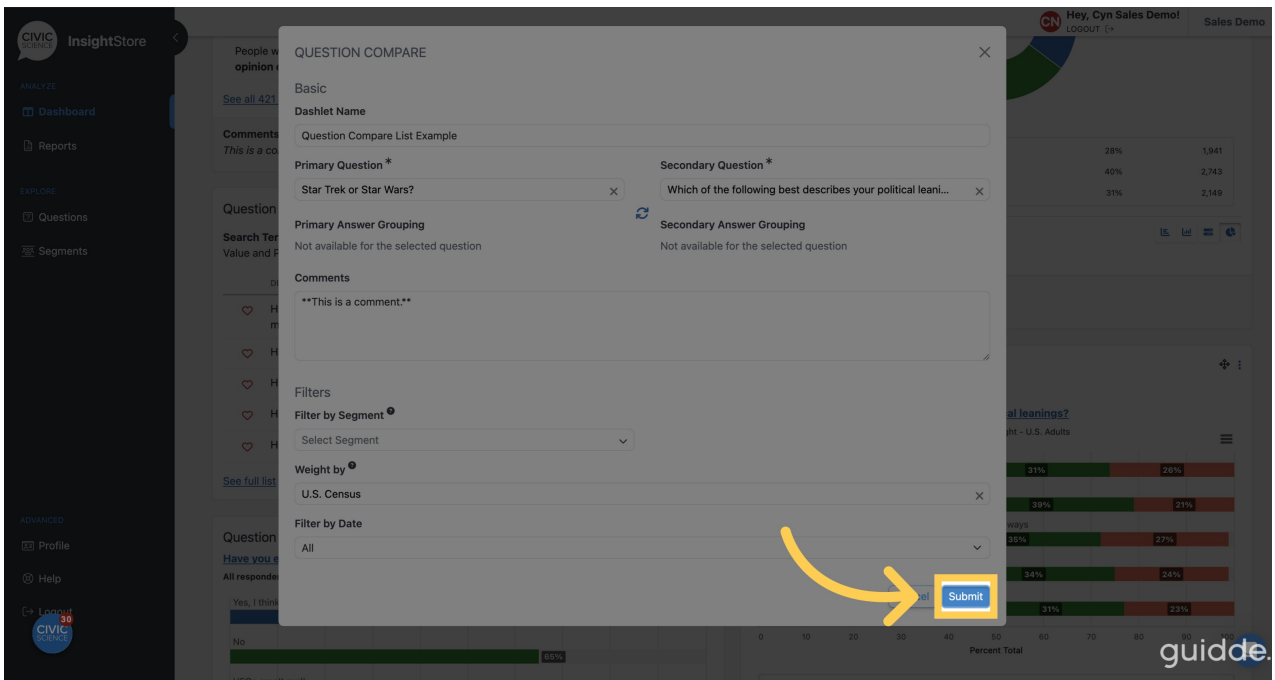

In this guide, you learned how to add, move, and edit a question compare dashlet.